

**Lambert Road, Brixton, SW2**

1 bedroom flat to let

**£403 Per Week**

Furnished

## Property Details

Keating Estates are proud to present this beautifully spacious and well-distributed one bedroom garden flat, situated on the ground floor of an attractive Victorian townhouse on a quiet, sought-after residential street just off Brixton Hill.

At the rear of the property, the open-plan reception room flows seamlessly into a contemporary kitchen and out onto a charming South-facing private garden. This outdoor space is both low maintenance and inviting perfect for relaxing or entertaining. The kitchen offers plentiful storage and generous worktop space, while the lounge area provides ample room for dining, socialising, or simply unwinding.

Wooden flooring runs throughout the flat, adding warmth and character. The bedroom, located at the front of the building, is a standout feature – generously sized and bathed in natural light from a beautiful bay window. It offers excellent space for storage and includes access to a useful loft area above. A sleek and stylish bathroom completes the property.

Location is key: Brixton tube station is just a ten-minute walk away, offering rapid Victoria Line connections into Central London. The vibrant and much-loved Brixton Village is also nearby, bursting with eateries, boutiques, and cultural flair. The wide green spaces of Brockwell Park are only a few

## Features

- Victorian
- South facing private garden
- One double bedroom
- Open plan reception and kitchen area
- Located a short walk from Central Brixton

Council tax band C      EPC rating E (49)





Lambert Road, Brixton, SW2

## Lambert Road, SW2

Approximate Gross Internal Area  
52.5 sq m / 565 sq ft

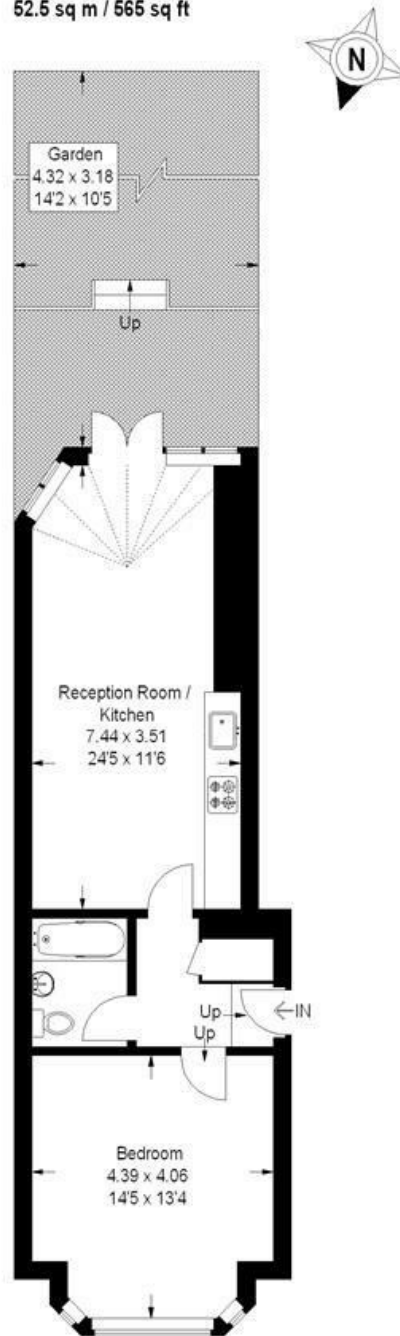

### Ground Floor

This plan is for layout guidance only. Not drawn to scale unless stated. Windows and door openings are approximate. Whilst every care is taken in the preparation of this plan, please check all dimensions, shapes and compass bearings before making any decisions reliant upon them. (ID176400)



Lambert Road, Brixton, SW2

